



**TIP-DRESSING AND TIP-REMOVAL TOOLS**  
 code 163R-03633 = MANUAL RATCHET TIP-DRESSER  
 code 19PA-01372 = HIGH QUALITY EXTRACTION TOOL  
 code 19PA-04380 = LOW COST EXTRACTION TOOL



Code: **MD\_C04**

Review date: 080529

TOTAL QUALITY MANAGEMENT

<b>RRM</b>	<b>APPLICATION: HANGING/STATIONARY MANUAL WELDING GUNS</b>
	<p>Handle = made of insulating anti slip material.          Cutter rotation = manhandled          Cutter rotation direction = clockwise, reversible.          Tip-dressing welding gun closing force = 90 ÷ 300 daN          Cutter holder = RFA (locked by a snap ring)          Distance between cutter center/ head edge= 26 mm          Tip dressing mode = closed welding gun and welding power off.</p>
<p><b>OVERALL DIMENSIONS</b>          X (length) = 420 mm          Y (width) = 55 mm          Z (height) = 20 mm with cutter installed          Overall weight: 0,500 Kg</p>	<p><b>MAINTENANCE</b>          Tip-dresser:          Gear cleaning: remove copper swarves through compressed air          Lubricate with anti-seizure liquid          Cutter : clean cutter after each tip-dressing</p>
<b>HIGH QUALITY EXTRACTION TOOL</b>	<b>APPLICATION: EXTRACTION AND DRIVING OF Ø10÷Ø21 mm ELECTRODES</b>
	<p><b>Features:</b>          Tool with integrated hammer for the driving of electrodes          Highly wear resistant          Material : Chrome-Vanadium Stainless steel (27CrMoV6-12)          Reduction of costs of the tools used in welding lines          Reduction of electrodes replacement time          Reduction of wear of electrodes holder, which can be caused by using improper tools (tongs , clamps etc.)</p> <p><b>OVERALL DIMENSIONS</b>          X (length) = 315 mm          Y (width) = 60 mm          Z (height ) = 20 mm          Overall weight of the tool = 0,400 Kg</p>
<b>LOW COST EXTRACTION TOOL</b>	<b>APPLICATION: EXTRACTION AND DRIVING OF Ø10÷Ø21 mm ELECTRODES</b>
	<p><b>Features:</b>          Material: zinc-coated steel          Reduction of costs of tools used in welding lines          Reduction of electrodes replacement time          Reduction of wear of electrodes holder, which can be caused by using improper tools (tongs, clamps etc.)</p> <p><b>OVERALL DIMENSIONS</b>          X (length) = 265 mm          Y (width) = 45 mm          Z (height ) = 10 mm          Overall weight of the tool: 0,270 Kg</p>

Drawings and models shown in this catalogue are properties of Sinterleghe S.r.l and protected under Ravitex® registered trademark. Sinterleghe S.r.l. reserve the rights to modify technical specifications and dimensions at any time without previous notice. Edition : 25-03-2009

**TIP-DRESSING AND TIP-REMOVAL TOOLS**  
 code 163R-03633 = MANUAL RATCHET TIP-DRESSER  
 code 19PA-01372 = HIGH QUALITY EXTRACTION TOOL  
 code 19PA-04380 = LOW COST EXTRACTION TOOL

Code: **MD\_C04**

Review date: 080529

TOTAL QUALITY MANAGEMENT

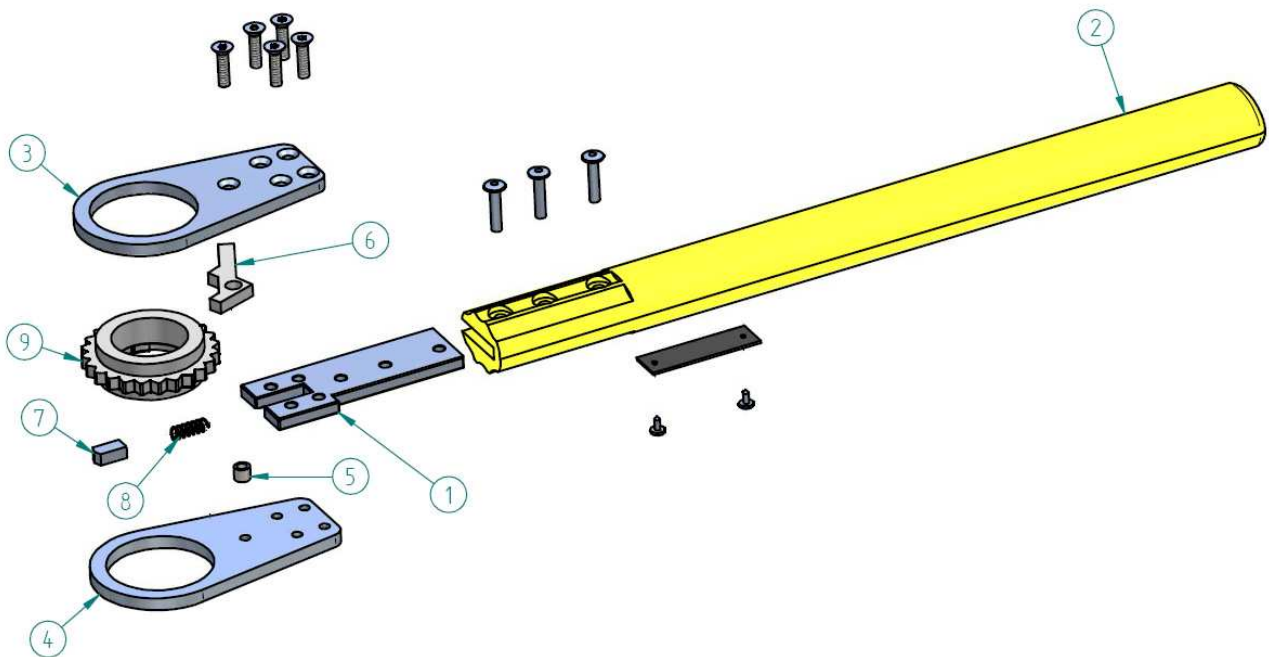

No.	RRM 002 Spare parts	Code	Pcs.
1	3 HOLES ADAPTOR FOR RRM HANDLE	10M2-03919	1
2	HANDLE FOR RRM	10M2-02137	1
3	UPPER PLATE RRM Ø40 L95 S5	10M2-02136	1
4	LOWER PLATE RRM Ø40 L95 S5	10M2-02133	1
5	SPACER RRM Ø6X4 L5	10M2-03588	1
6	RRM LEVER L43 S4.8 Ø6.2 NITR	10M2-02132	1
7	SLIDER RRM 12X6X4.8	10M2-02131	1
8	SPRING Ø5 L14 RRM	10M2-02135	1
9	CUTTER HOLDER GEAR RRM Z24 M2 Ø51 RFA	10M2-02134	1
COMMERCIAL NOTE: spare parts can only be purchased as follows			
A	HANDLE FOR RRM	10M2-02137	1
B	RRM COMPLETE TIP-DRESSING HEAD CONSISTS ON No. 1-3-4-5-6-7-8-9	29RI-04867	1